

*UriSponge®*

For Urine Collection,  
Transport, and  
Preservation



**Copan**  
innovating together



Copan's UriSponge® is an innovative urine specimen collection, transport, and preservation system designed to streamline laboratory workflow. By combining a user-friendly dip-and-close method with a unique boric acid-free preservative formulation, UriSponge® simplifies the collection process, and maintains specimen integrity minimizing risk of specimen rejection. The system preserves bacterial and yeast load for up to 48 hours at both room and refrigerated temperatures, supporting accurate detection and cultivation of uropathogenic organisms. Ideal for standard clinical laboratory procedures, UriSponge® offers a dependable solution for efficient specimen handling from collection to analysis.



#### **User-Friendly**

Simply dip into the sample cup, close, and send for analysis.



#### **Save Time and Costs**

Reduces expenses and waste by eliminating additional consumables and simplifying collection with a quick dip-and-close method—no need for transfer devices or mixing.



#### **No Fill Line**

Maintains correct urine-to-preservative ratio, reducing bacterial overgrowth and minimizing specimen rejection.



#### **Safe and Reliable**

Eliminates the need for needles or urine transfer straws, reducing additional steps and injury risk.



#### **Automation Ready**

Standardized tubes designed for automatic specimen processors.



#### **Unique Preservation Solution**

Boric acid-free formulation providing a dependable choice for urine specimen collection.



### **Innovative Design for Streamlined Collection**

UriSponge® features a screw-cap tube with a plastic applicator stick and dual cylindrical sponges, simplifying urine collection. The sponges are loaded with preservatives, that upon contact with urine maintain sample stability throughout transport. With no need for precise fill lines or additional mixing, the system ensures the correct urine-to-preservative ratio while eliminating consumables like transfer devices.

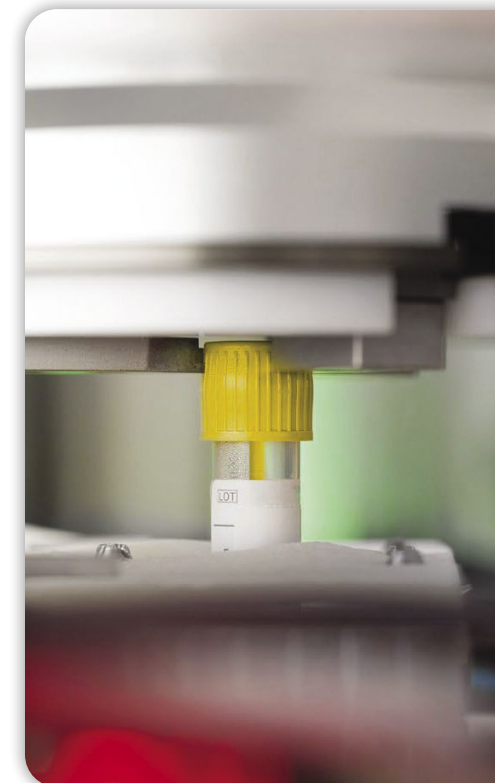

### **Seamless Integration for High-Volume Urine Processing**

Urine is the most frequently received specimen in the microbiology laboratory, and the UriSponge® system makes collection, transport, and automated processing easier than ever. UriSponge® integrates seamlessly with Copan's WASP® Walk-Away Specimen Processor, which automates essential microbiology specimen processing tasks, including planting and streaking. UriSponge® and Copan's full laboratory automation solutions offer a streamlined approach to specimen handling from collection through analysis, aimed at enhancing laboratory productivity and consistency.

## How to use UriSponge®

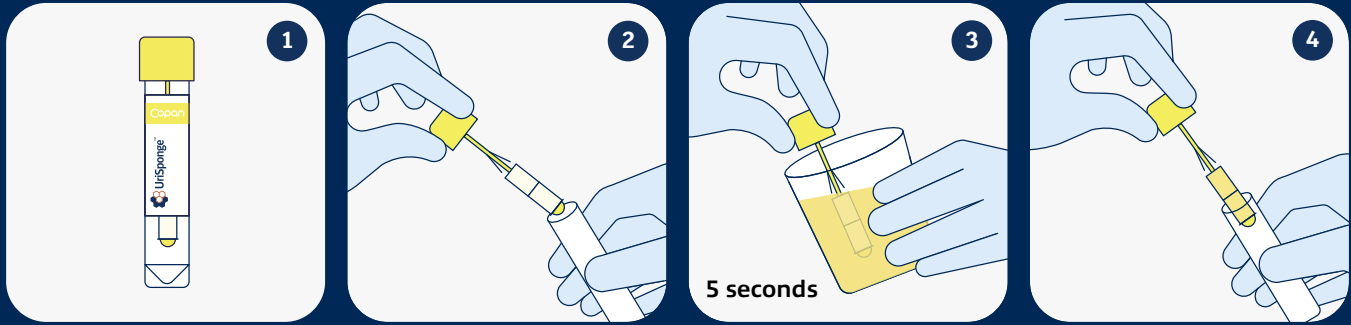

## Ordering information

Cat. No.	Description	Pack size
8U033550	UriSponge® in 12x80 mm tube 	300 pieces (6 boxes of 50 pieces)
	UriSponge® in 16x100 mm tube 	300 pieces (6 boxes of 50 pieces)



Scan for more information.

**Copan**  
innovating together

These products may not be available in all countries. Please refer to [www.copanusa.com](http://www.copanusa.com) for the most recent version of this document. Always consult product technical documentation for complete information. The use of this product in association with diagnostic kits or instrumentation should be validated by the end user. All trademarks, logos and brand names are the property of their respective owners. ©2024 COPAN Diagnostics Inc. All rights reserved.  
Code:UriSponge\_Brochure\_CD\_11\_2024

[COPANUSA.com](http://COPANUSA.com) [800.216.4016](tel:800.216.4016) [@COPANUSA](https://twitter.com/COPANUSA) [CommunicationsUS@copangroup.com](mailto:CommunicationsUS@copangroup.com) [/COPANUSA](https://facebook.com/COPANUSA)

**COPAN Diagnostics, Inc.**  
26055 Jefferson Avenue | Murrieta, CA 92562 USA